



3 Merrivale Close KINCUMBER NSW

4 2 2

This lovely family home features four bedrooms, two bathrooms and a double lock up garage. Located only a 350m stroll to Kincumber Broadwater foreshore and walking distance to shops, cafes and public transport. The property has been very well maintained and is in mostly original condition. It features multiple living areas with strategically placed sky lights and ceiling fans throughout. The master bedroom is complete with an ensuite and built-in wardrobes.

Type : House
Land Size : 629 sqm
View : <https://www.changeproperty.com.au/sale/nsw/central-coast-region/kincumber/residential/house/8549847>

- * 3 Separate living areas
- * Lovely bright and spacious sunroom with air-conditioning
- * Double lock up garage with internal access and remote control
- * 629m2 block in a highly sought after location

[For full version visit the website](https://www.changeproperty.com.au)



Tom O'Gorman
02 4369 2222



GROUND FLOOR



3 MERRIVALE CLOSE, KINCUMBER



| | |
|--------------|---------------------|
| GROUND LEVEL | : 157m ² |
| GARAGE | : 35m ² |
| PATIO | : 11m ² |
| TOTAL | : 203m ² |

Disclaimer : Plans prepared by Key2Exposure. Scale in metres. Indicative only. Dimensions are approximate. All information contained herein is gathered from sources we believe to be reliable. However we cannot guarantee its accuracy and interested persons should rely on their own enquiries.



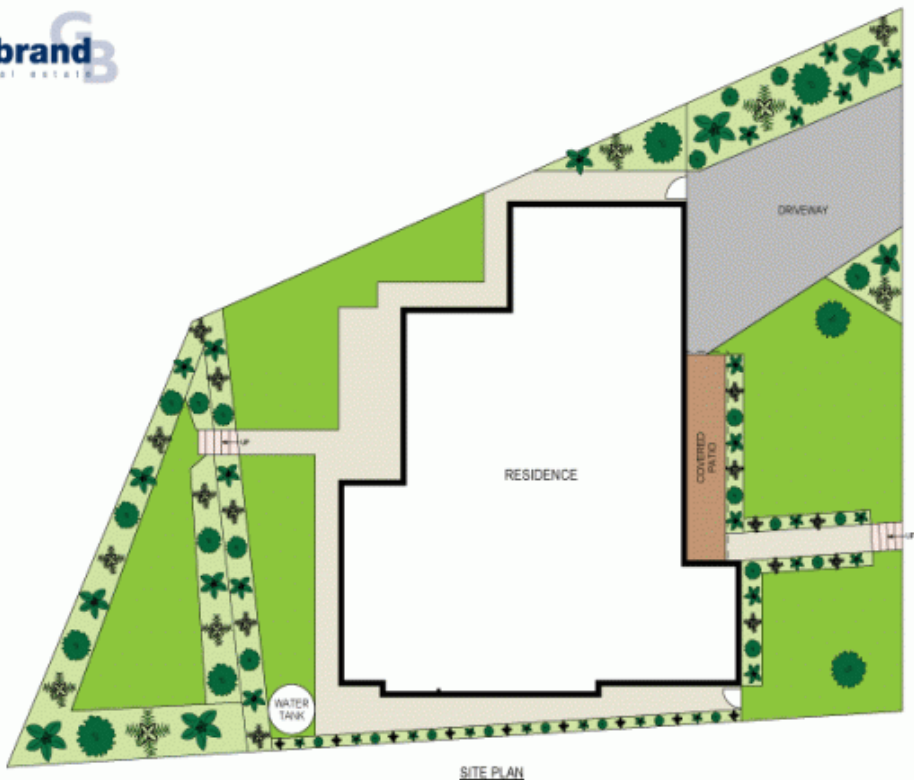

SITE PLAN



3 MERRIVALE CLOSE, KINCUMBER

SCALE (METRES)

Disclaimer : Plans prepared by Key2Exposure. Scale in metres. Indicative only. Dimensions are approximate. All information contained herein is gathered from sources we believe to be reliable. However we cannot guarantee its accuracy and interested persons should rely on their own enquiries.