



3 Woodward Crescent KINCUMBER NSW

3 1 3

Set in a quiet cul de sac and surrounded by reserve on 2 sides this home will provide you with the unique opportunity to enjoy the morning presence of wallabies and birdsong of native parrots - all within a stone's throw of the local primary school, shops and transport.

Immaculately presented, the home has been thoughtfully designed with a formal lounge room and a galley style kitchen connecting the formal dining and informal living/dining areas. Complete with a large covered outdoor entertaining area there is nothing left to do except sit back and enjoy the private, fully fenced backyard.

Other attributes include:

[For full version visit the website](https://www.changeproperty.com.au)

Type : House
Land Size : 889 sqm
View : <https://www.changeproperty.com.au/sale/nsw/central-coast-region/kincumber/residential/house/8549870>



Tom O'Gorman
02 4369 2222

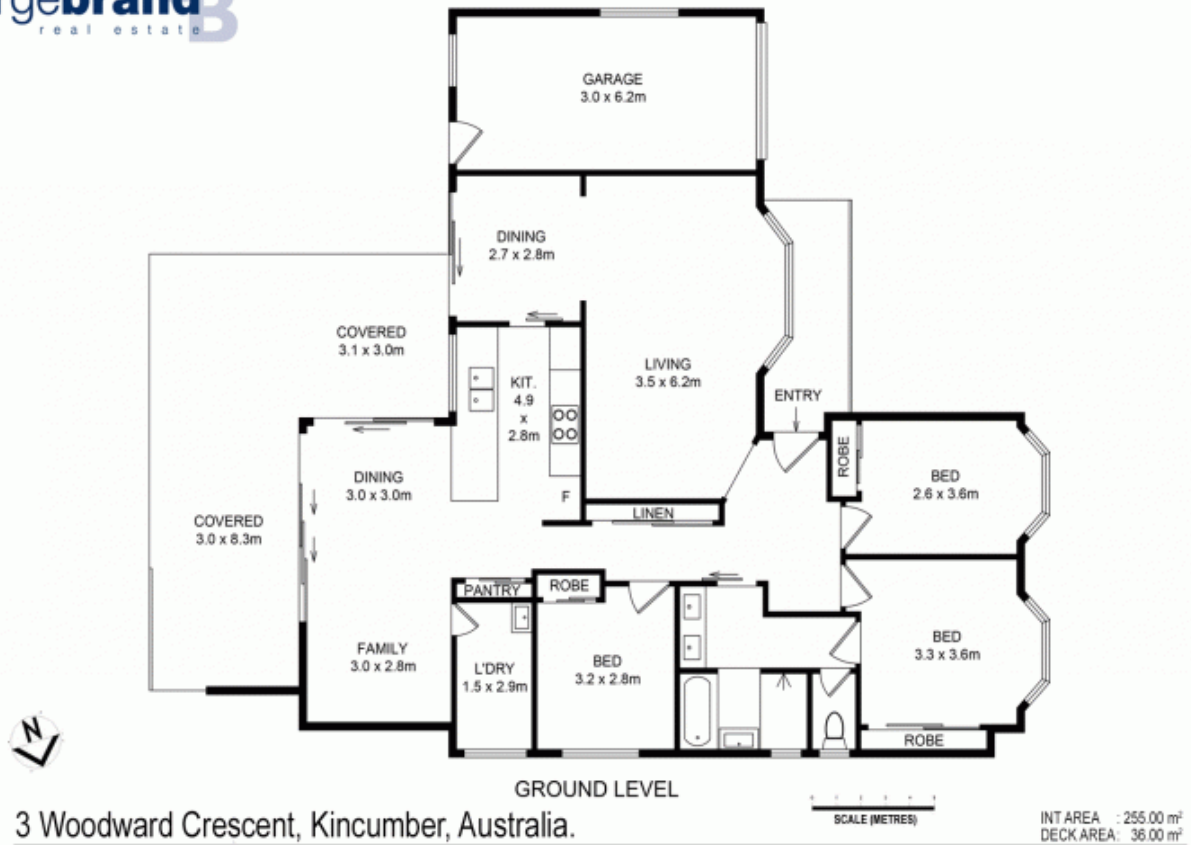

3 Woodward Crescent, Kincumber, Australia.

Disclaimer : Plans prepared by Key2Exposure. Scale in metres. Indicative only. Dimensions are approximate. All information contained herein is gathered from sources we believe to be reliable. However we cannot guarantee its accuracy and interested persons should rely on their own enquiries.



SITE PLAN



3 Woodward Crescent, Kincumber, Australia.

SCALE (METRES)

INT AREA : 255.00 m²
DECK AREA: 36.00 m²

Disclaimer : Plans prepared by Key2Exposure. Scale in metres. Indicative only. Dimensions are approximate. All information contained herein is gathered from sources we believe to be reliable. However we cannot guarantee its accuracy and interested persons should rely on their own enquiries.

