



14 Joalah Road KINCUMBER NSW

3 1

Set on a level east facing block this light and bright three bedroom brick and tile home has character in spades and would be perfect for first home buyers or those looking to downsize.

With polished timber floors throughout, the lounge room features a raked ceiling, ceiling fans, split system air conditioner. The newly renovated kitchen and dining area opens to a covered deck where you can enjoy afternoon sunshine and views of Kincumba Mountain. There is also a large covered & paved alfresco area with bain-marie - perfect for entertaining all year round!

Just a short level distance to the school, bus stop & shops

[For full version visit the website](https://www.changeproperty.com.au)

Type : House
Land Size : 605 sqm
View : <https://www.changeproperty.com.au/sale/nsw/central-coast-region/kincumber/residential/house/8549892>

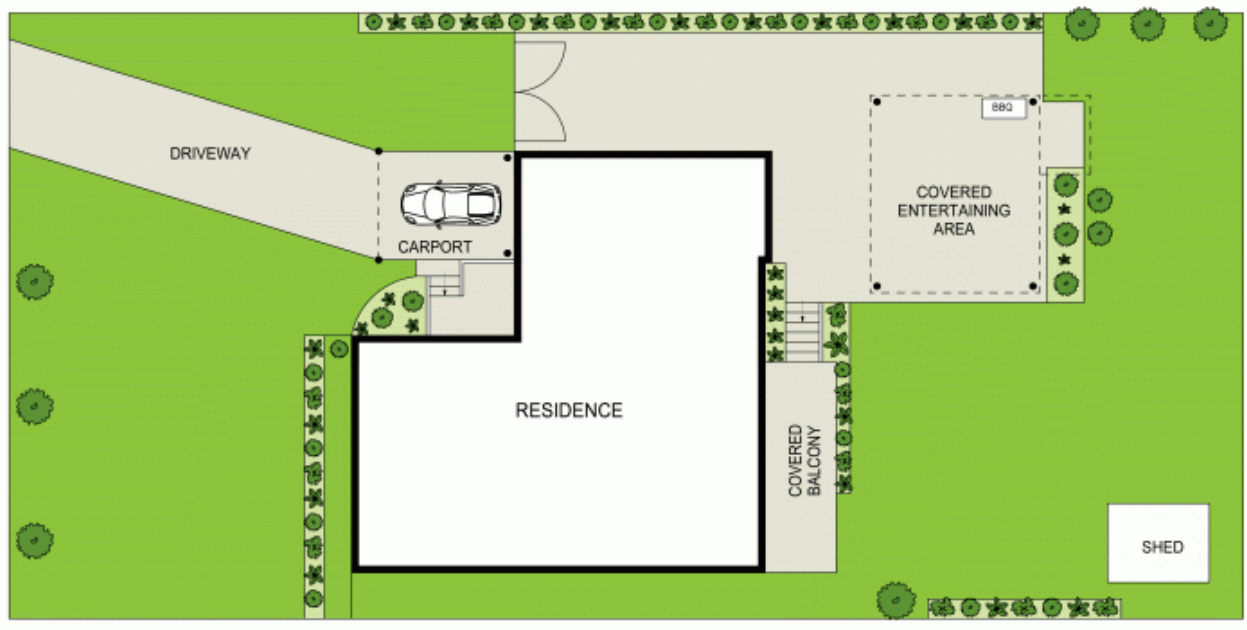

14 Joalah Road, Kincumber

Disclaimer : Plans prepared by Key 2 Exposure. Scale in metres. Indicative only. Dimensions are approximate. All information contained herein is gathered from sources we believe to be reliable. However we cannot guarantee its accuracy and interested persons should rely on their own enquiries.



14 Joalah Road, Kincumber

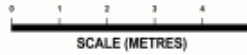

INTERNAL FLOOR AREAS : 120m²
OUTDOOR AREAS : 40m²

Disclaimer : Plans prepared by Key 2 Exposure. Scale in metres. Indicative only. Dimensions are approximate. All information contained herein is gathered from sources we believe to be reliable. However we cannot guarantee its accuracy and interested persons should rely on their own enquiries.