

## 19 Figtree Bay Drive KINCUMBER NSW

4 2 2

Superbly presented, this modern and spacious home offers luxury living at it's finest and is located within the prestigious Figtree Bay Estate, only metres to the Kincumber foreshore and cycle way.

With high ceilings and blackbutt timber floors the home is centred around the fabulous open plan gourmet kitchen, dining and living area that opens to the covered outdoor entertaining area. Complete with a soundproof theatre room and four huge bedrooms plus a study, the design of the home offers comfortable family living, all within walking distance to schools, shops and transport with the surf beaches of Avoca Beach and Copacabana less than a 10 minute drive.

[For full version visit the website](https://www.changeproperty.com.au)

**Type** : House  
**Land Size** : 650 sqm  
**View** : <https://www.changeproperty.com.au/sale/nsw/central-coast-region/kincumber/residential/house/8549895>



**Tom O'Gorman**  
02 4369 2222



19 Figtree Bay Drive, Kincumber



INTERNAL FLOOR AREAS : 212m<sup>2</sup>  
 OUTDOOR ENTERTAINING AREA : 32m<sup>2</sup>  
 GARAGE AREA : 46m<sup>2</sup>

Disclaimer : Plans prepared by Key 2 Exposure. Scale in metres. Indicative only. Dimensions are approximate. All information contained herein is gathered from sources we believe to be reliable. However we cannot guarantee its accuracy and interested persons should rely on their own enquiries.



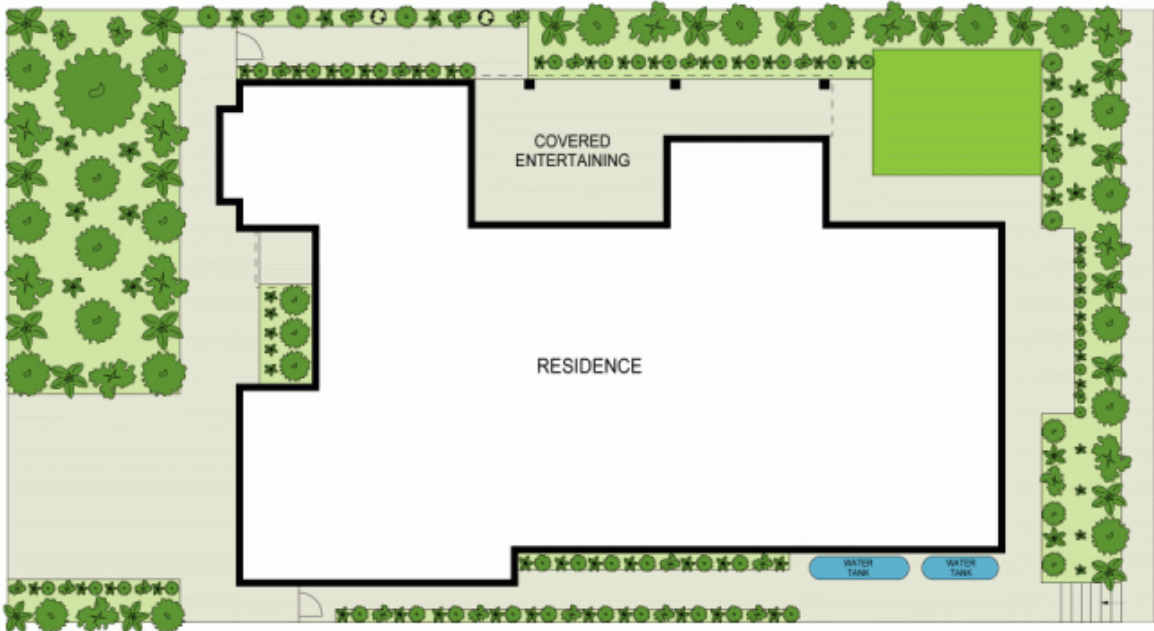

19 Figtree Bay Drive, Kincumber

Disclaimer : Plans prepared by Key 2 Exposure. Scale in metres. Indicative only. Dimensions are approximate. All information contained herein is gathered from sources we believe to be reliable. However we cannot guarantee its accuracy and interested persons should rely on their own enquiries.