



**9-15 Allawa Close BENSVILLE NSW**

4 2 2

Set on approx. 2 acres of level land that enjoys all day sun, this fabulous 4 bedroom single level home "Reflections" is just waiting for your family and a pony! With entry via a grand circular driveway the home has a wrap around verandah with a lovely deck at the rear overlooking the inground pool.

**Type** : House  
**Land Size** : 8005 sqm  
**View** : <https://www.changeproperty.com.au/sale/nsw/central-coast-region/bensville/residential/house/8549904>

Inside you will find a formal entry with a fantastic guest or master suite to the left with separate entry, a huge walk in robe and a full bathroom. The rest of the home provides formal and informal living and dining areas and a beautiful country style kitchen. Complete with a study, three additional bedrooms and a two way main bathroom which can also be accessed by the second bedroom.

[For full version visit the website](#)



9-15 Allawa Close, Benville



|                     |                     |
|---------------------|---------------------|
| INTERNAL FLOOR AREA | : 213m <sup>2</sup> |
| EXTERNAL AREA       | : 187m <sup>2</sup> |
| SUMMER HOUSE AREA   | : 26m <sup>2</sup>  |
| GARAGE/CARPORT AREA | : 54m <sup>2</sup>  |
| STABLE AREA         | : 21m <sup>2</sup>  |

Disclaimer : Plans prepared by Key 2 Exposure. Scale in metres. Indicative only. Dimensions are approximate. All information contained herein is gathered from sources we believe to be reliable. However we cannot guarantee its accuracy and interested persons should rely on their own enquiries.



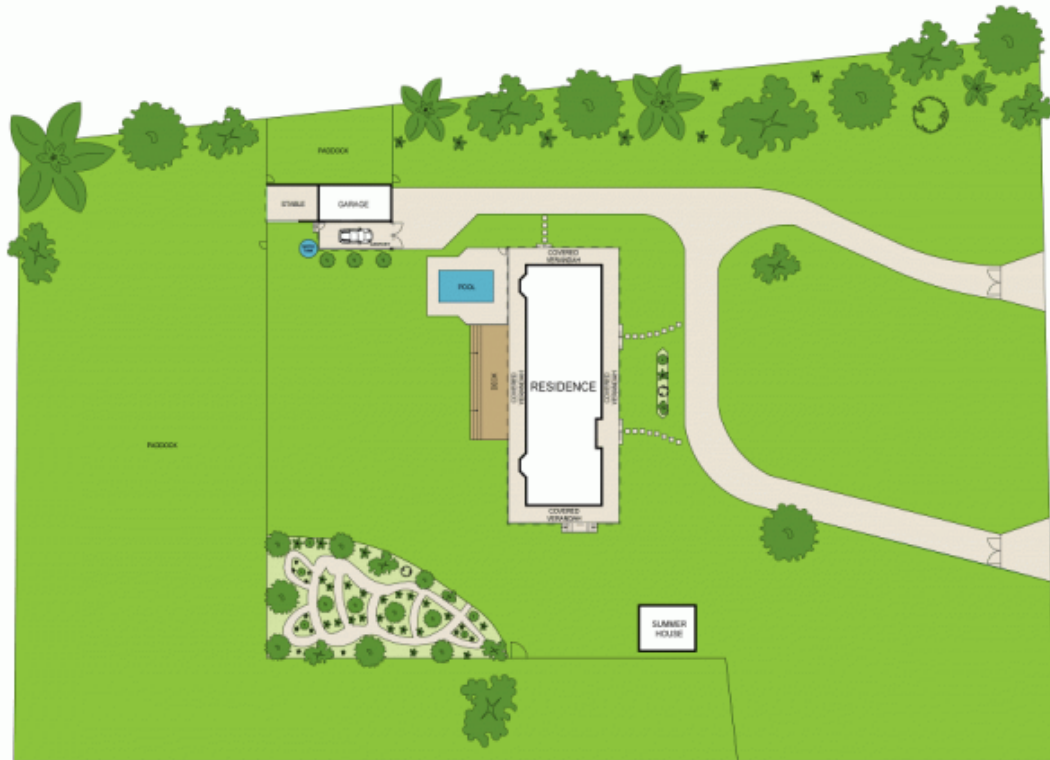

9-15 Allawa Close, Benville

Disclaimer : Plans prepared by Key 2 Exposure. Scale in metres. Indicative only. Dimensions are approximate. All information contained herein is gathered from sources we believe to be reliable. However we cannot guarantee its accuracy and interested persons should rely on their own enquiries.