

10 Shannon Close KINCUMBER NSW

3 1 1

Set at the end of a quiet cul-de-sac on a level 604sqm block, this modern home presents beautifully and is ready to move into.

Perfect for young families, investors or retirees, this fully renovated home boasts a modern and neutral colour scheme throughout. The open plan living is light-filled and extremely functional, allowing the entertaining areas to flow with ease from the tiled living, kitchen and dining areas, opening up to a rear covered entertaining deck. With a private, fully fenced level rear yard that backs onto a reserve, the home is perfect for entertaining friends and family, and allowing the kids or pets to roam in a secure and safe setting. The home is conveniently positioned

Type : House
Land Size : 604 sqm
View : <https://www.changeproperty.com.au/sale/nsw/central-coast-region/kincumber/residential/house/8549918>

[For full version visit the website](#)



Tom O'Gorman
02 4369 2222



Damian Rutherford
02 4369 2222



10 Shannon Close, Kincumber

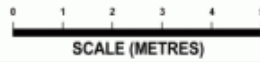

INTERNAL FLOOR AREA : 112m²
 GARAGE AREA : 17m²
 EXTERNAL AREA : 58m²

Disclaimer : Plans prepared by Key 2 Exposure. Scale in metres. Indicative only. Dimensions are approximate. All information contained herein is gathered from sources we believe to be reliable. However we cannot guarantee its accuracy and interested persons should rely on their own enquiries.



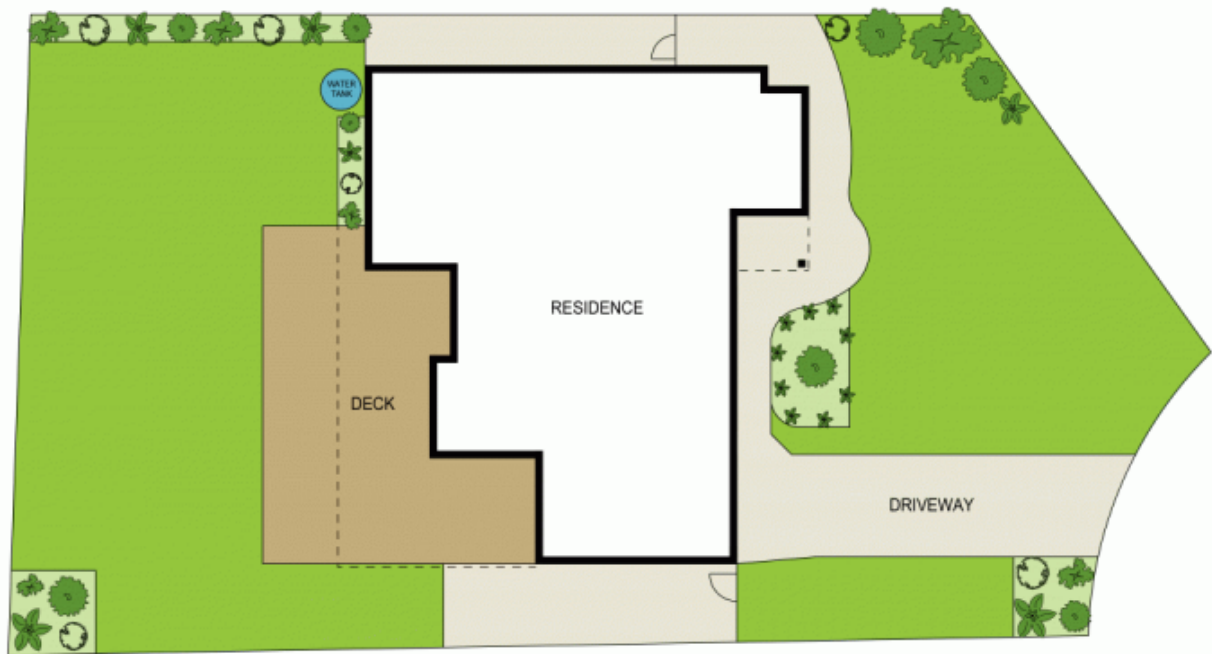

10 Shannon Close, Kincumber

Disclaimer : Plans prepared by Key 2 Exposure. Scale in metres. Indicative only. Dimensions are approximate. All information contained herein is gathered from sources we believe to be reliable. However we cannot guarantee its accuracy and interested persons should rely on their own enquiries.