



2/2 Island View Drive KINCUMBER NSW

2 1 1

Just moments to shops, schools and transport, this well maintained villa is one of 2 in the complex and offers glimpses of Brisbane Water.

The tiled entry leads to the air-conditioned open plan living and kitchen which flows into the fully enclosed sunroom. There are two bedrooms, the master with built-in-robos and a ceiling fan, a main bathroom and an internal laundry with additional toilet. Other features of this neat and tidy villa include:

- * Just 10 minutes to Avoca Beach
- * Walk to the Kincumber foreshore path
- * Auto single garage

[For full version visit the website](https://www.changeproperty.com.au)

Type : Villa
View : <https://www.changeproperty.com.au/sale/nsw/central-coast-region/kincumber/residential/villa/8549941>



Tom O'Gorman
02 4369 2222



Damian Rutherford
02 4369 2222



2/2 Island View Drive, Kincumber

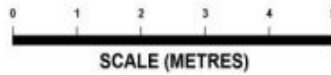

INTERNAL FLOOR AREA 89m²
GARAGE AREA 19m²
EXTERNAL AREA 3m²

Disclaimer : Plans prepared by Key 2 Exposure. Scale in metres. Indicative only. Dimensions are approximate. All information contained herein is gathered from sources we believe to be reliable. However we cannot guarantee its accuracy and interested persons should rely on their own enquiries.



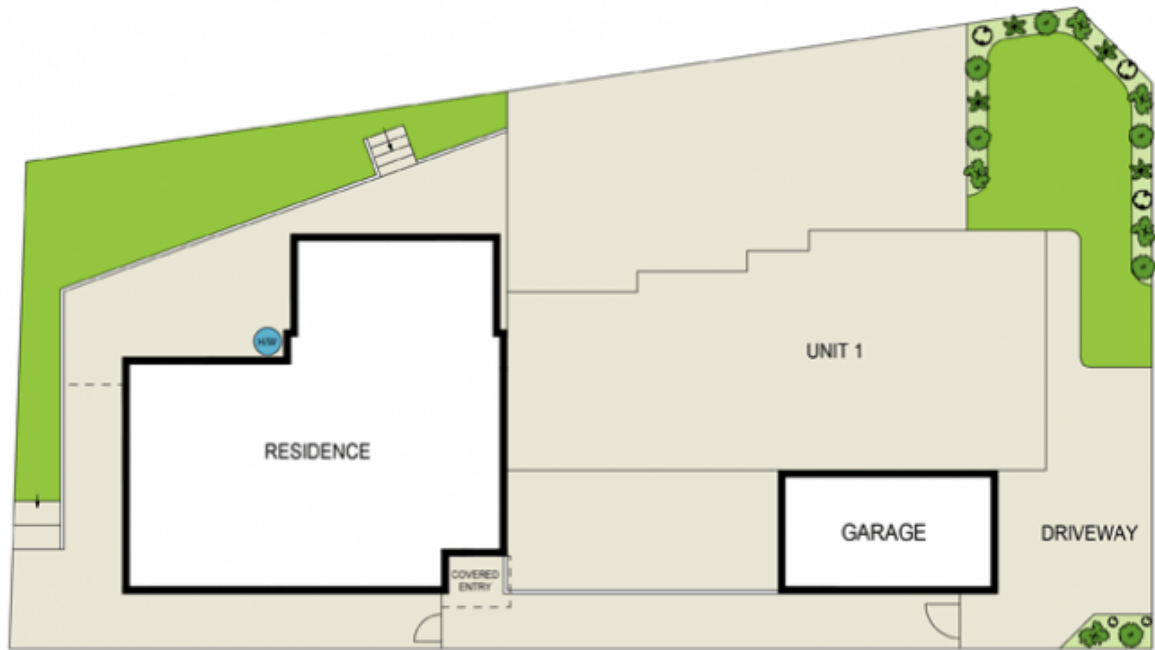

2/2 Island View Drive, Kincumber

Disclaimer : Plans prepared by Key 2 Exposure. Scale in metres. Indicative only. Dimensions are approximate. All information contained herein is gathered from sources we believe to be reliable. However we cannot guarantee its accuracy and interested persons should rely on their own enquires.

