



1 Yurara Close KINCUMBER NSW

4 2 2

Set in a beautifully quiet pocket of Kincumber on a huge 921sqm block this original home is located at the end of the cul-de-sac next to Pinyari Park - there could be no better location for your family!

The home provides spacious formal and informal living areas together with a large covered entertaining area that overlooks the private fully fenced backyard. With rear yard access and plenty of room for your boat and caravan this home is a must to inspect!

- * Air conditioning
- * 4 bedrooms, 3 with BIRs, master bedroom with ensuite
- * Kitchen with s/s wall oven & electric cooktop

[For full version visit the website](https://www.changeproperty.com.au)

Type : House
Land Size : 921 sqm
View : <https://www.changeproperty.com.au/sale/nsw/central-coast-region/kincumber/residential/house/8550069>



Tom O'Gorman
02 4369 2222



Damian Rutherford
02 4369 2222

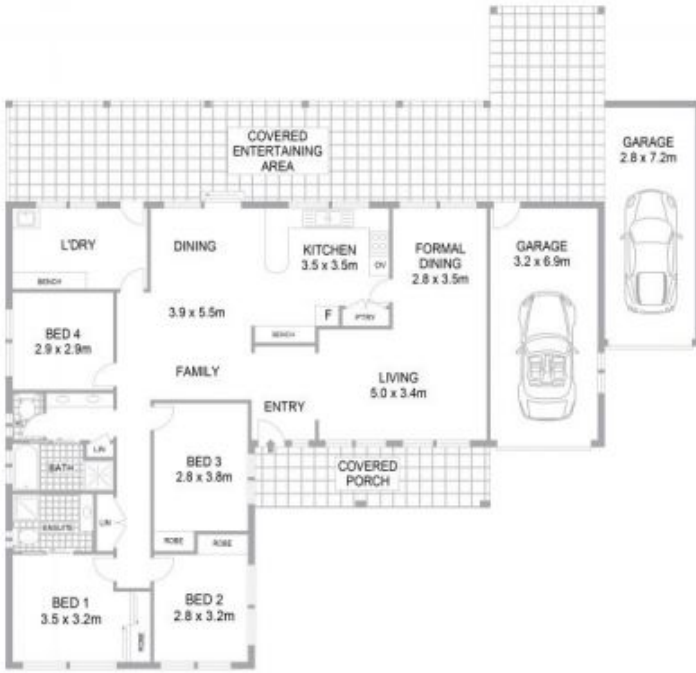

SITE PLAN

INTERNAL FLOOR AREA 186sq^m
LAND SIZE 924sq^m



Indicative only. All dimensions and element positions are approximate. Information on this plan comes from sources we believe to be accurate, but its accuracy is not guaranteed. Interested parties should make and rely on their own inquiries

1 YURARA CLOSE, KINCUMBER