



16 Mathew Street KINCUMBER NSW

4 3 2

Situated opposite a beautiful park, playground and just 5km to Copacabana & Avoca Beach this large family home is set on a low maintenance landscaped block in a quiet cul-de-sac.

The entry-level boasts a formal living and dining room with combustion fireplace and cathedral ceilings, a stunning modern kitchen with stainless steel appliances, plus a family room that opens to a generous covered entertaining deck. There are three spacious bedrooms to this level, the master with a walk-in robe and ensuite. Downstairs is the 4th bedroom, ensuite and another living room providing perfect in-law accommodation or teenager's retreat.

Type : House
Price : \$ 820,000
Land Size : 691 sqm
View : <https://www.changeproperty.com.au/sale/central-coast-region/kincumber/residential/house/8550075>

[For full version visit the website](https://www.changeproperty.com.au)



Tom O'Gorman
02 4369 2222



Damian Rutherford
02 4369 2222



GROUND FLOOR

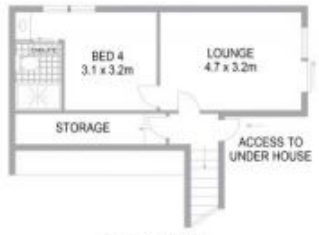

FIRST FLOOR



SITE PLAN



INTERNAL FLOOR AREA 270m²
 LAND SIZE 732m²

Indicative only. All dimensions and element positions are approximate. Information on this plan comes from sources we believe to be accurate, but its accuracy is not guaranteed. Interested parties should make and rely on their own inquiries