



14 Joalah Road KINCUMBER NSW

3 1

Set on a level east facing block this light and bright three bedroom brick and tile home has character in spades and would be perfect for first home buyers, investors or those looking to downsize.

With polished timber floors throughout, the lounge room features a raked ceiling, ceiling fans and split system air conditioner. The newly renovated kitchen and dining area opens to a deck where you can enjoy afternoon sunshine and views of Kincumba Mountain. There is also a large paved alfresco area for entertaining.

Just a short level distance to the school, bus stop & shops the home also offers:

[For full version visit the website](https://www.changeproperty.com.au)

Type : House
Land Size : 605 sqm
View : <https://www.changeproperty.com.au/sale/nsw/central-coast-region/kincumber/residential/house/8550184>



Tom O'Gorman
02 4369 2222



Damian Rutherford
02 4369 2222

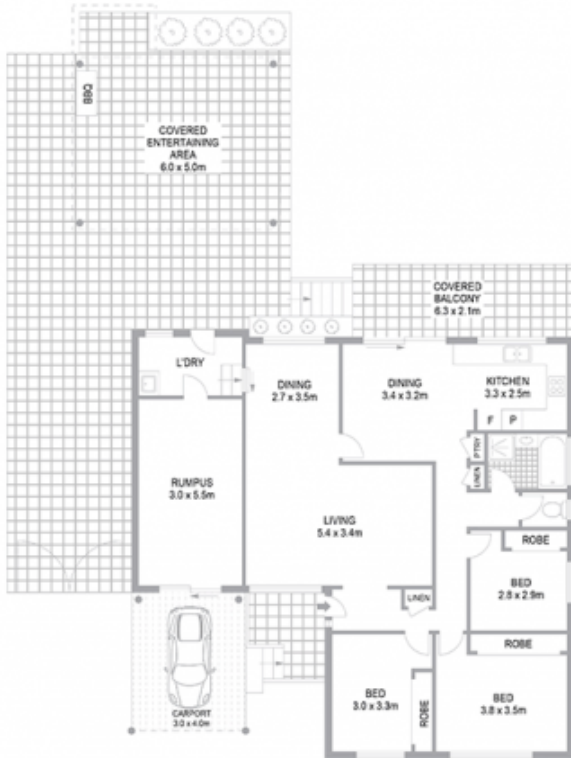

SITE PLAN



INTERNAL FLOOR AREA 120m²
LAND SIZE 518m²

Indicative only. All dimensions and element positions are approximate. Information on this plan comes from sources we believe to be accurate, but its accuracy is not guaranteed. Interested parties should make and rely on their own inquiries

14 JOALAH ROAD, KINCUMBER