



7 Katherine Crescent GREEN POINT NSW

4 2 2

Immaculate and centrally located to schools, shops and transport this lovely, near new home offers an appealing floorplan of 4 bedrooms and high ceilings, creating a sense of light and space.

The heart of the home is the open plan living, kitchen and dining room that leads to the covered alfresco entertaining area where on summer days you can enjoy the serene outlook of Kincumba Mountain. The kitchen features granite benchtops, a natural gas cooktop and a sizeable butler's pantry. The home also features:

- * Bedrooms with BIR's, master with air-con, WIR & ensuite
- * Study

[For full version visit the website](https://www.changeproperty.com.au/sale/nsw/central-coast-region/green-point/residential/house/8550357)

Type : House
Land Size : 565 sqm
View : <https://www.changeproperty.com.au/sale/nsw/central-coast-region/green-point/residential/house/8550357>

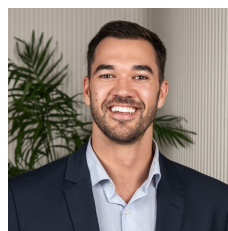

Damian Rutherford
02 4369 2222



Tom O'Gorman
02 4369 2222

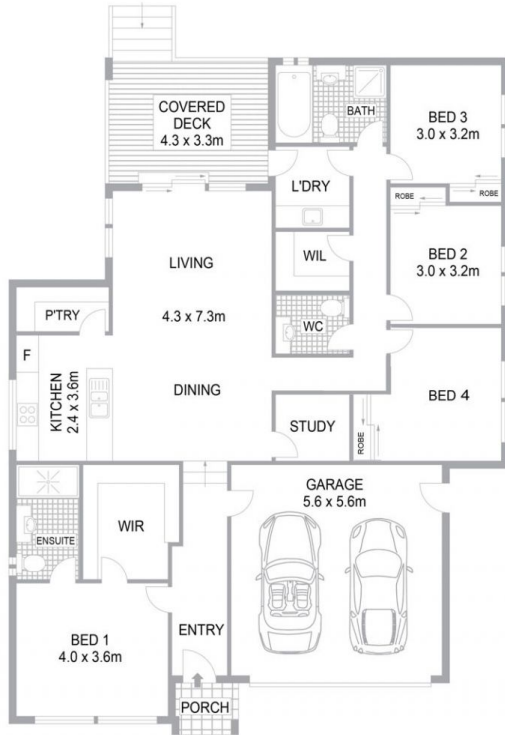

SITE PLAN

INTERNAL FLOOR AREA - 182m²
 LAND SIZE - 565m²

Indicative only. All dimensions and element positions are approximate. Information on this plan comes from sources we believe to be accurate, but its accuracy is not guaranteed. Interested parties should make and rely on their own inquiries

7 Katherine Crescent Green Point