



12A Olive Kari Close Kariang NSW

3 2 1

This lovely duplex is set within a tranquil pocket of Kariang, close to all conveniences, including the M1, schools, parkland and walking trails within the Brisbane Water National Park.

The entry leads to a spacious, light filled open plan living, kitchen and dining area and flows to the outdoor patio and large grassy backyard for children and pets to enjoy. The master bedroom offers a built-in-robe and ensuite whilst the two additional bedrooms also have built-ins and share the modern master bathroom.

- * Open plan living
- * Modern kitchen with gas cooktop

[For full version visit the website](https://www.changeproperty.com.au/sale/nsw/central-coast-region/kariang/residential/house/8550456)

Type : House
Price : \$ 800,000
View : <https://www.changeproperty.com.au/sale/nsw/central-coast-region/kariang/residential/house/8550456>

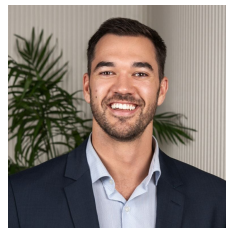

Damian Rutherford
02 4369 2222

12A Olive Kari Close, Kariong NSW 2250

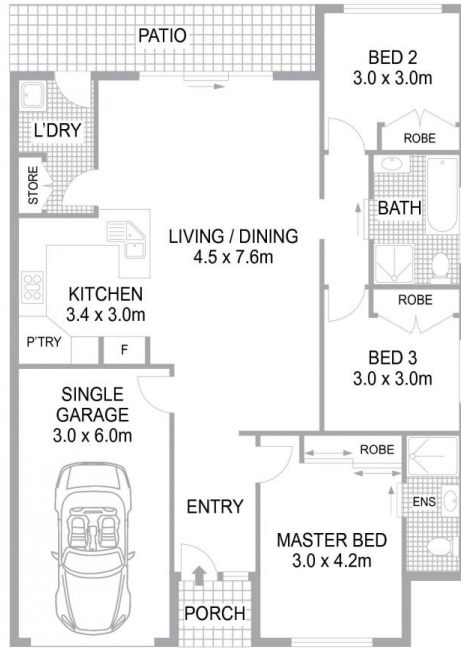

FLOOR PLAN



SITE PLAN

INTERNAL FLOOR AREA 136m²
LAND SIZE 324m²

Indicative only. All dimensions and element positions are approximate. Information on this plan comes from sources we believe to be accurate, but its accuracy is not guaranteed. Interested parties should make and rely on their own inquiries

georgebrand

