



5 Letitia Close GREEN POINT NSW

4 2 1

This well maintained brick and tile home is surrounded by quality homes in leafy Green Point. Walking distance to Woodport Public & Erina high, shops, public transport & sporting facilities. Ten minutes to the M1, Gosford hospital & trains and a quick drive to Terrigal beaches & cafes. Property has been internally painted since photos were taken.

Type : House

View : <https://www.changeproperty.com.au/lease/nsw/central-coast-region/green-point/residential/house/8550820>

* Formal & informal living areas, lounge room with split system air conditioning

* Kitchen with loads of cupboard space, gas oven & cooktop & new rangehood

[For full version visit the website](https://www.changeproperty.com.au)

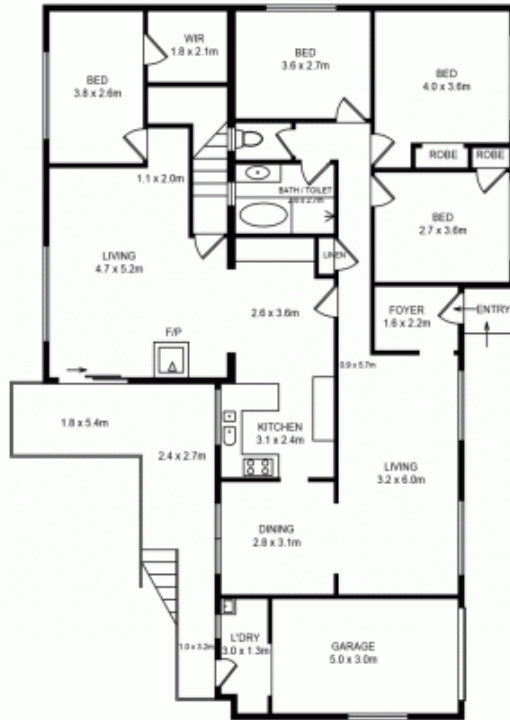

UPPER LEVEL

5 Letitia Close, Green Point, Australia.



TOTAL INT AREA	: 174.00 m ²
TOTAL DECK AREA	: 20.00 m ²
GARAGE AREA	: 15.00 m ²

Disclaimer : Plans prepared by Key2Exposure. Scale in metres. Indicative only. Dimensions are approximate. All information contained herein is gathered from sources we believe to be reliable. However we cannot guarantee its accuracy and interested persons should rely on their own enquiries.

